

The following resident has been matched to your facility. This match has been created by our Placement Specialist Billy, based on the vacancies and preferences you have provided to us. Please find below a detailed profile on the resident including their care needs, preferences and financial capacity.

Active Placement Stage: Active Search

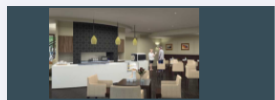

Matched Facility: Demonstration Forest
Facility Contact: 07 99 999 999 - Erika Spanos

John Smith is looking for permanent for John Smith who is 79 years old . They are wanting to tour Demonstration Forest in the next week or so and the placement urgency is urgently - within 7 days. Please contact John Smith on mobile: 04123456789.



Resident Details more details

Resident Name: John Smith
Resident DOB: 09/10/1940 (79 years)

Current Location: Hospital
Hospital: Demonstration Hospital
Estimated Discharge Date: 23/08/2020

Contact Person: John Smith
Power of Attorney: None In Place
Contact Number: M: 04123456789
Preferred Contact Method: Any

Relationship to Resident: Self
Power Of Attorney Name: N/A
Email: john@smith.com.au
Preferred Contact Time: Any

Client Key Concerns: Find vacancy by hospital discharge date

Client Key Priorities: Location

[Internal Notes](#) [ACD Notes](#)

06/03/2020 13:25:00
 Placement Status updated to **ACTIVE**

Type your new notes here

Save Notes

Care Details more details

Care Required: Permanent
ACFI Estimate: \$\$150

Funding Type: Residential Aged Care

ACA Approvals: Residential Permanent

Referral Codes: Respite I-123456789

ACFI Details: Active physical assistance required with eating. // Physical assistance required with mobility. Comment: walker. // Physical assistance required with some elements of personal hygiene and toileting. // Resident is incontinent. BEH Assessment: Memory - noticeable problems day-to-day & requires assistance. Resident has diagnosis of Alzheimers disease (early onset). Resident is at risk of absconding, getting out of facility, getting lost. CHC Assessment: Assistance required with daily medications. Complex pain management required involving therapeutic massage and/or pain management. Arthritis indicated.

Placement & Timelines more details

Urgency: Urgently - Within 7 Days
Tour Timeline: Next Week Or So

Timeline Drivers: Declining Cognition

Location Drivers: Proximity To Primary Residence

ACA Status: ACA Done - Waiting On Letter Back

Already Toured Any Facilities? No

Room Preferences Single Room With Private Ensuite
 Single Room With Shared Ensuite
 Shared Room

Location Preferences Paradise Point - 2 KM Radius

Finances more details

Home Ownership Status: Owned Outright With Self
Financial Capacity: Supported
RAD Capacity Amount: NIL

Protected Person Status: No
Home Ownership Status: Owned Outright With Self
Other Assests: \$ 20,000
Other Income (Annual): NIL
Pension Status: Full Pension
Centrelink Form Status: Form not commenced
RAD Funding Method:

Summary

Placement Opportunity Summary

more details

John Smith is looking for permanent care for himself. He is currently in hospital and will be discharged next week. John has been having frequent falls recently and would like to move in residential care instead of back home where he lives alone. If you can assist, please contact John on 0412345678.

Action this introduction

Accept For Review

Invite For Tour

Decline Introduction

Share With Colleague

Last Action: 19/08/2020 09:44:14 Active

Client Messaging

Type your message here

Send Message

Tour Booked	Tour Date Time	Tour Status
Yes	20/08/2020 12:45	Requested By Client

Client Optional Tour Message

I would like to book a tour please.

Decline Tour

Reschedule Tour

Accept Tour

Decision Drivers

Client Key Concerns Find vacancy by hospital discharge date

Client Key Priorities Location

Are your vacancies up-to-date?

Great partnerships require communication. At Aged Care Decisions we want to make sure that we are providing you with the best possible matches for your facility. Take a moment to confirm that the data we have for this facility is correct - we don't want to miss sending you a great match.

Current Vacancies - **Demonstration Forest**

Single Room Shared Room Respite Secure Dementia RAD Supported Smokers Allowed

Vacancy Notes:

Update Now